

Hwy #1 - #8, Spences Bridge Signing



Legend

Structure Roads

- Bridge
- Culvert
- Sign
- Tunnel
- Retaining Wall
- Other

Signs

- Numbered Routes (DSA)
- Annotation (TRIM)
- Water - Text (TRIM)
- Communities
- Water - Points (TRIM)

Water - Lines (TRIM)

- Canal
- Dam
- Dam - Beaver
- Ditch
- Falls
- Flume
- Rapids
- River/Stream - Definite
- River/Stream - Dry
- River/Stream - Indefinite
- River/Stream - Left Bank
- River/Stream - Right Bank
- Dam - section.Base
- Flooded Land - Inundated
- Lake - Definite
- Lake - Indefinite
- Lake - Intermittent
- Reservoir - Definite
- Reservoir - Intermittent
- Marsh
- Swamp
- Glacier
- Icefield
- Breakwall/Breakwater - Large
- Dyke/Levee
- Island - Definite
- Sand Bar
- Sea Wall
- Provincial Boundary (1:2M)
- Boundary (International)

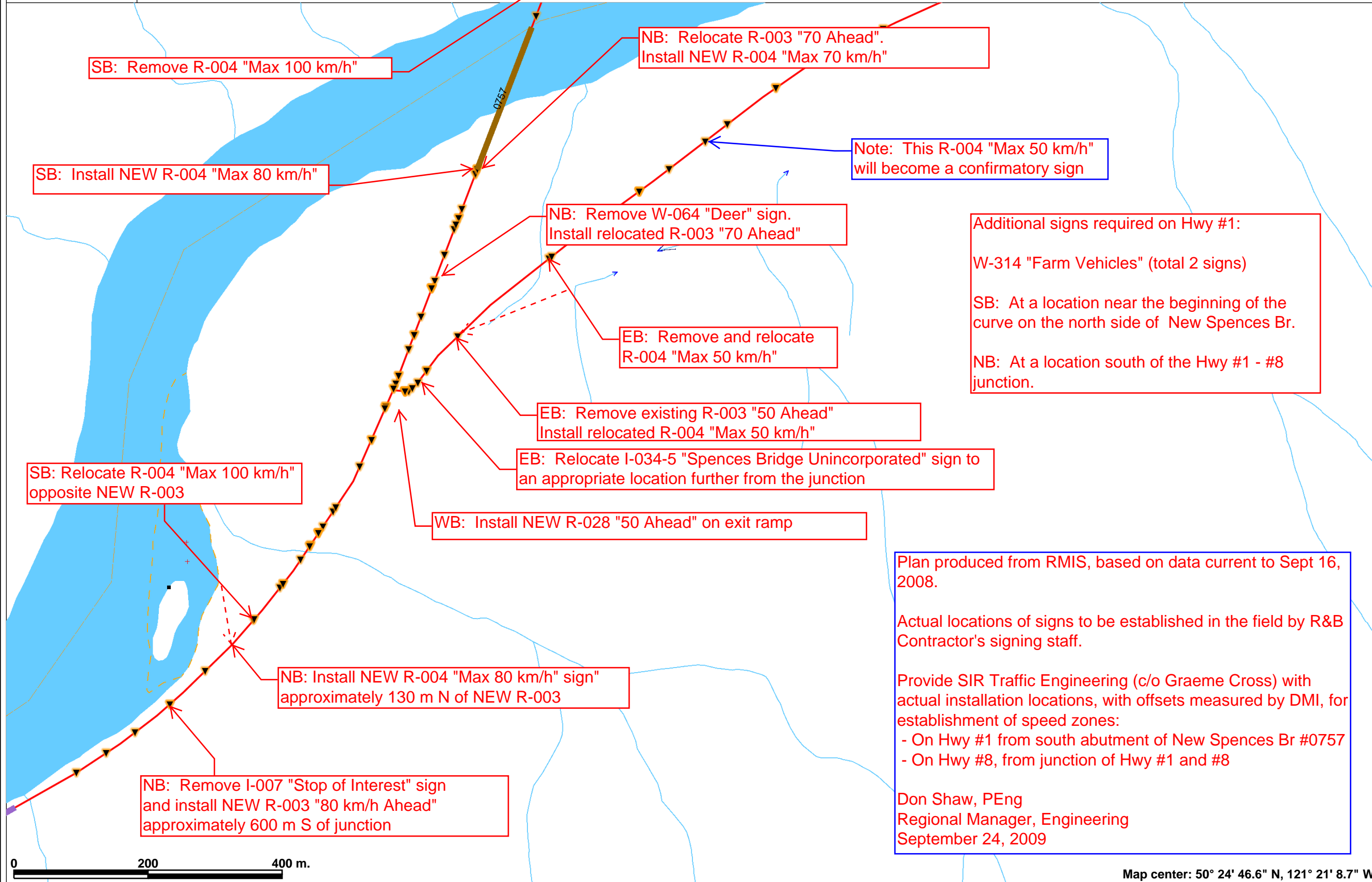

Plan produced from RMIS, based on data current to Sept 16, 2008.

Actual locations of signs to be established in the field by R&B Contractor's signing staff.

Provide SIR Traffic Engineering (c/o Graeme Cross) with actual installation locations, with offsets measured by DMI, for establishment of speed zones:

- On Hwy #1 from south abutment of New Spences Br #0757
- On Hwy #8, from junction of Hwy #1 and #8

Don Shaw, PEng
Regional Manager, Engineering
September 24, 2009

This map is a user generated static output from an Internet mapping site and is for general reference only. Data layers that appear on this map may or may not be accurate, current, or otherwise reliable. THIS MAP IS NOT TO BE USED FOR NAVIGATION.

Map center: 50° 24' 46.6" N, 121° 21' 8.7" W

Scale: 1:5,813