

# Coordinate Corrections to Geodetic Control Monuments in Powell River Wildwood / Historic District

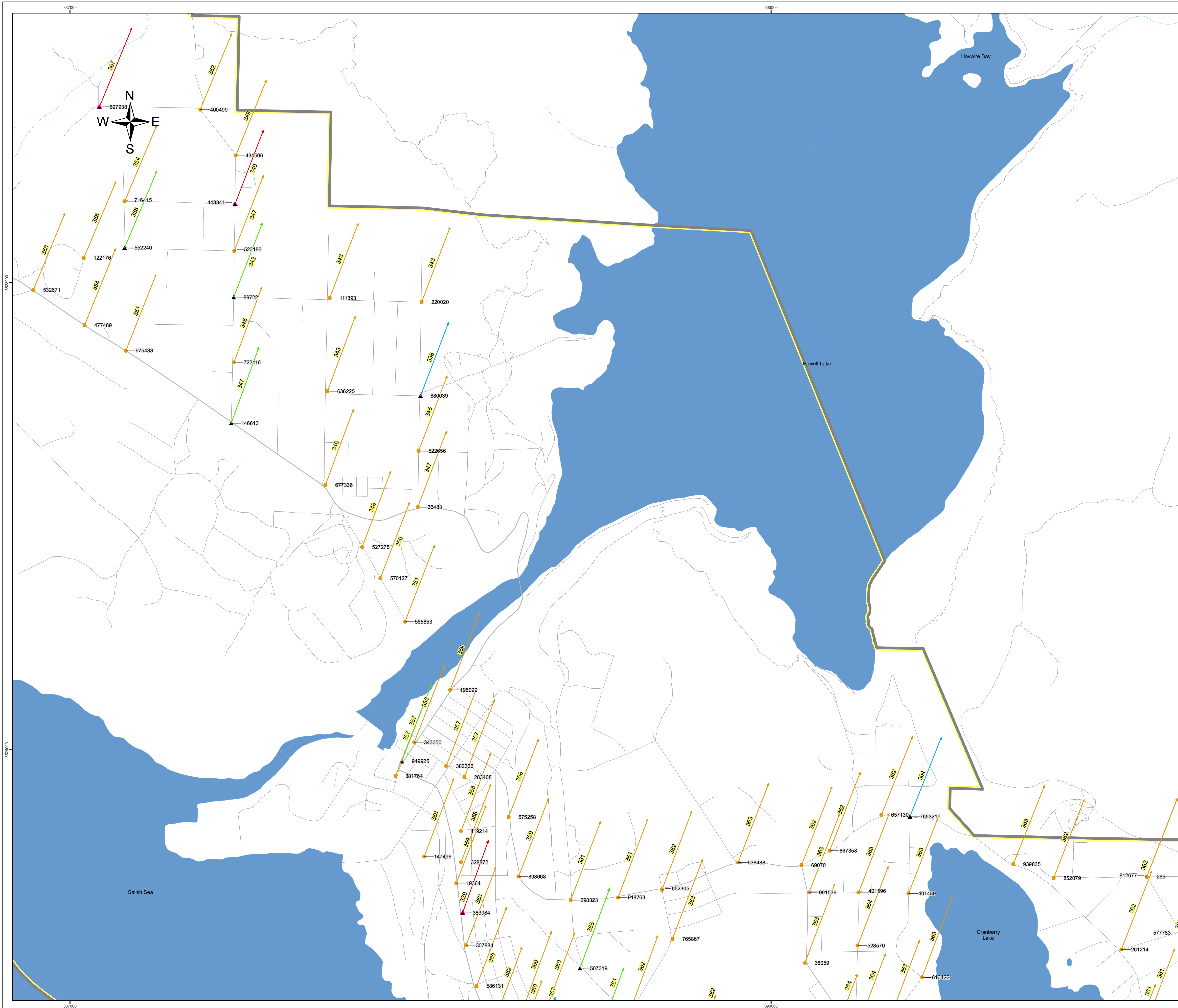

- Static GNSS Observation
- RTK GNSS Observation
- Outlier
- Modelled Correction
- 33** → Vectors shown on plot indicate the directions of proposed coordinate corrections. (units = mm)
- GCM Not Re-observed
- ▲ Sample GCM
- ▲ Outlier Sample (not used as input to model)
- ▭ Integrated Survey Area Boundary

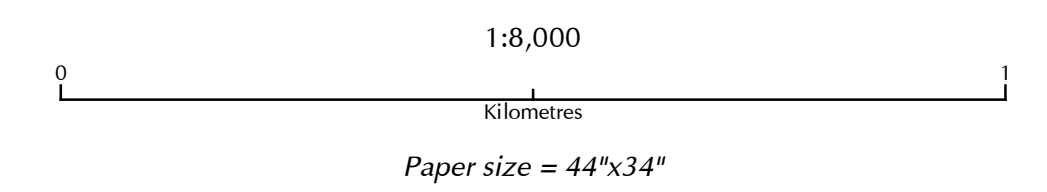

Produced by: GeoBC  
Date: November 6, 2020



Date: January 4th, 2022



L:\GIS\Jacob\Interpolations\_Review\Powell\_River\_Review\Powell\_River\_Final\_Quarter\_EBH\3\Powell\_River\_Cover\_Plot.mxd [2020.11.06] [15.13.17]