



Advancing Mass Timber in BC Codes

Opening up Opportunities for Mass Timber Construction in BC

- Effective immediately, BC owners and developers can build almost any type of building using mass timber, opening up markets for mass timber products.
- BC has expanded mass timber construction opportunities for taller buildings, up to 18 storeys high, and many more types of buildings such as restaurants, shops, care facilities, warehouses.
- Mass Timber products, engineered for strength, are solid, structural load-bearing components such as columns, beams, and panels.

BENEFITS INCLUDE:

- ✔ Sustainable, low carbon construction
- ✔ Affordability through prefabrication & reduced construction times
- ✔ Competitiveness & productivity
- ✔ Value-added forestry
- ✔ Digital innovation
- ✔ Biophilia for health and well-being

To learn more about mass timber, visit
naturallywood.com

UBC Brock Commons Tallwood House
Acton Ostry Architects

Photo: Brudder Productions
Courtesy of naturallywood.com

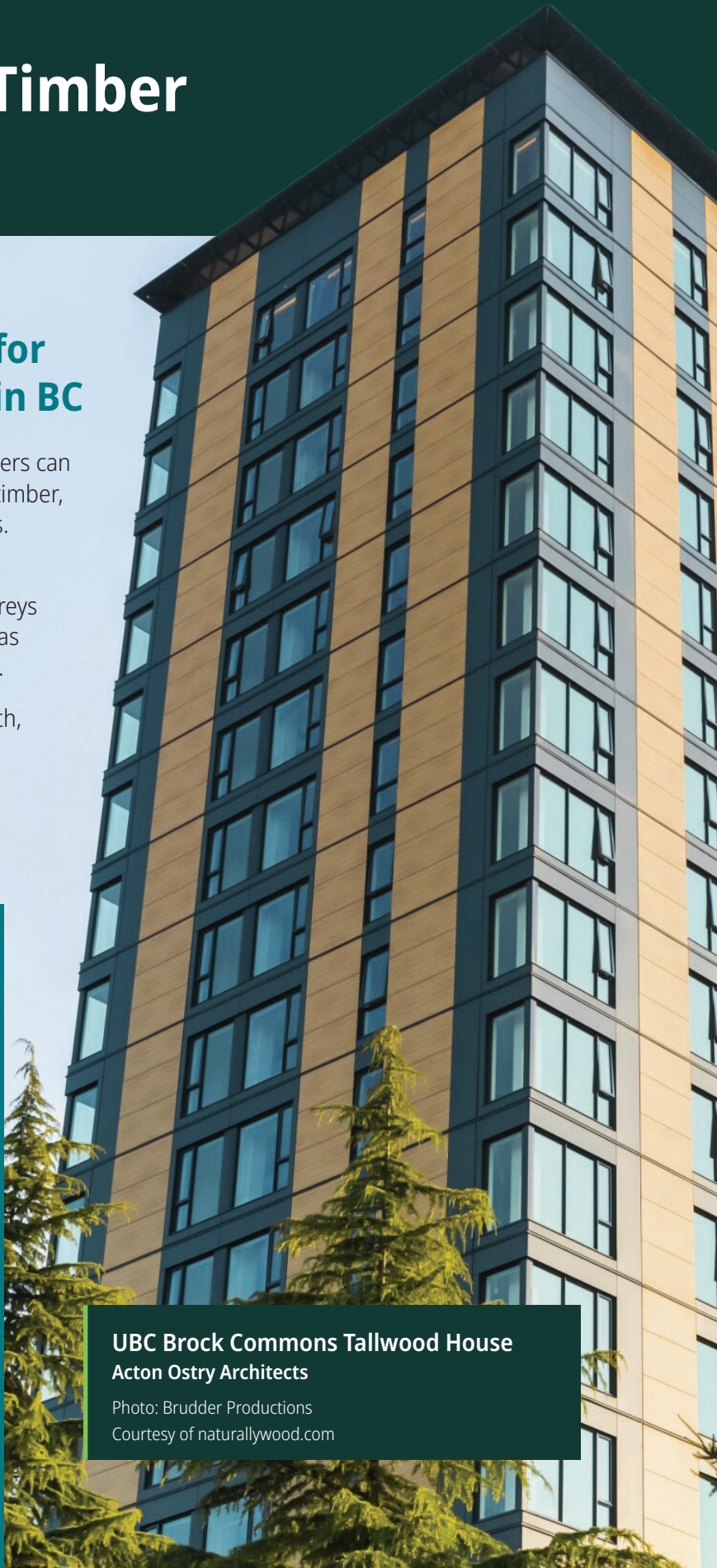

What's New in the BC Codes?

NEW BUILDING TYPES AND GREATER HEIGHTS THAN PREVIOUSLY PERMITTED

Building Type	Maximum Number of Storeys	Required Encapsulation Rating (Minutes)
School, Library, Restaurant, Community Centre (A-2 Occupancy)	18 12 6	70 50 0
Assisted Living, Care Facility, Hospice (B-3 Occupancy)	10 6 4	70 50 0
Apartment, Hotel, Dormitory (C Occupancy)	18 12 8	70 50 0
Office, Bank, Medical/Dental (D Occupancy)	18 12 9	70 50 0
Market, Shop, Supermarket (E Occupancy)	12 8 6	70 50 0
Factory, Workshop, Laboratory (F-2 Occupancy)	10 7 5	70 50 0
Warehouse, Parking Garage (F-3 Occupancy)	12 8 5	70 50 0

NEW ENCAPSULATION REQUIREMENTS ARE TAILORED TO SCALE OF THE BUILDING

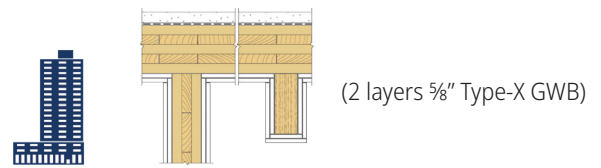

70-minute
requires full encapsulation

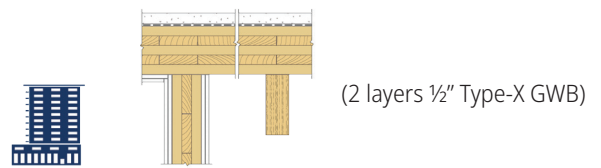

50-minute
permitted wood exposure as per existing requirements

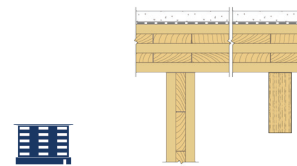

0-minute
permitted full exposure except in select, critical areas (exits, vertical shafts, public corridors)

Expanded Opportunities for Mass Timber Construction

