



Proposed Airpo

LOT
314

L 905
KIRK

L 378
GNAI FR.

L 210
GIBB FR.

L 906
ALL RIGHT FR.

ATLIN - YUKON HIGHWAY

L 257
GOLD No. 2





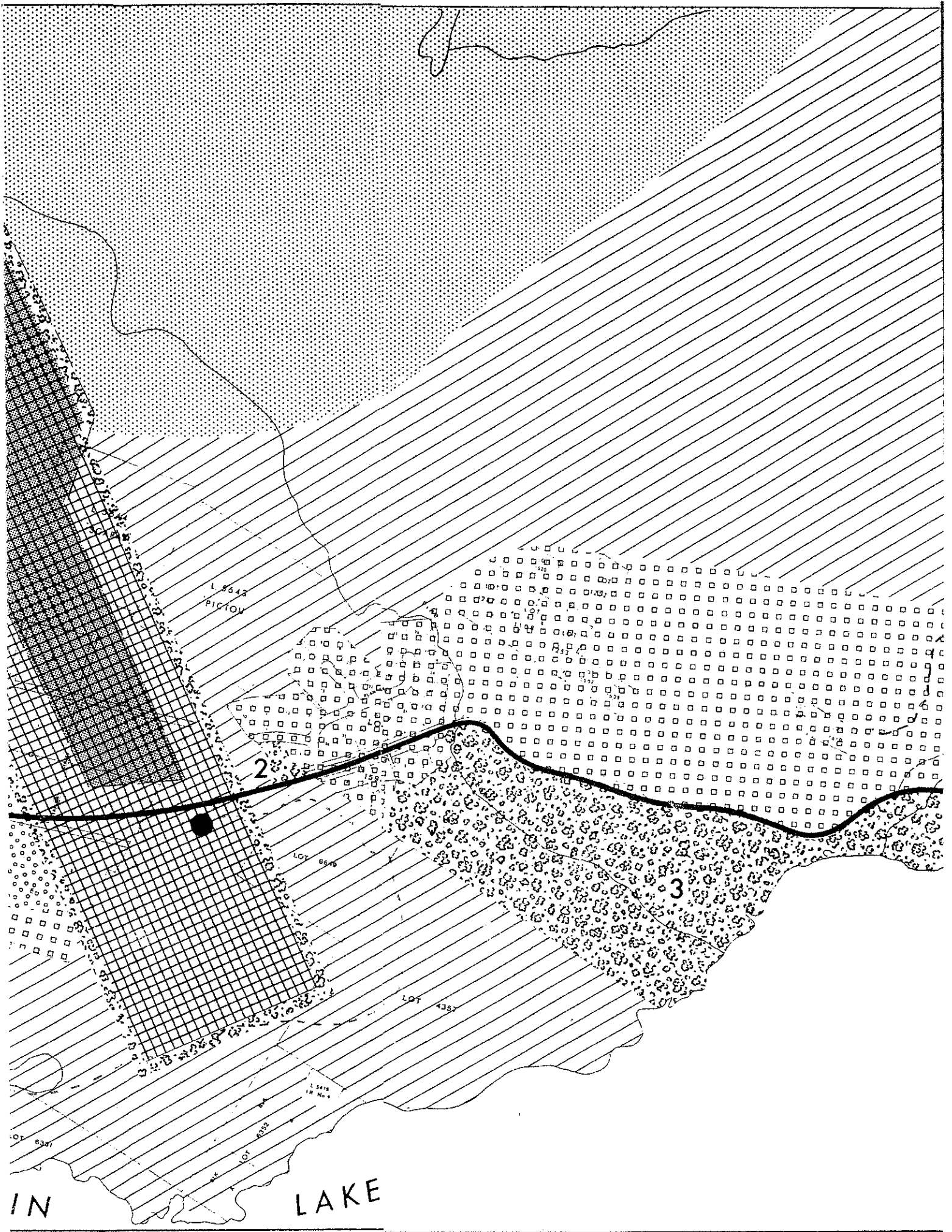

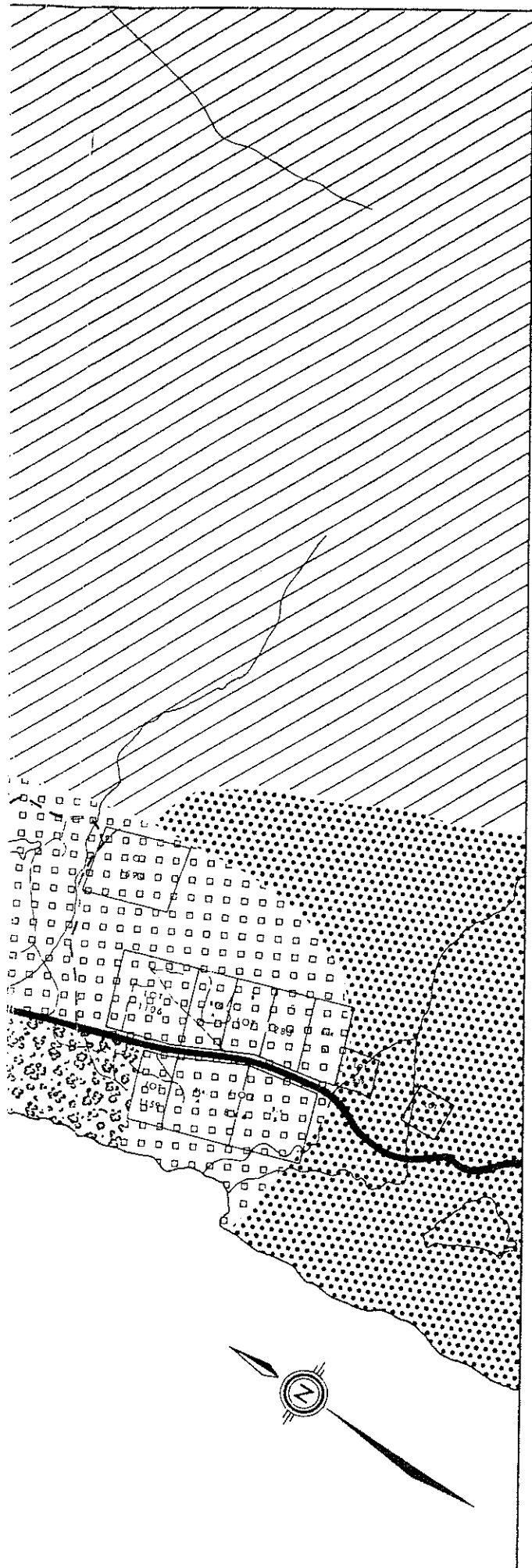

13
FIRST ISLAND

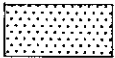
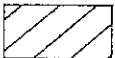
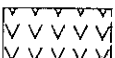
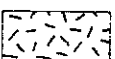
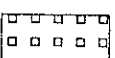
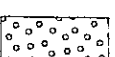
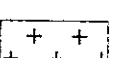
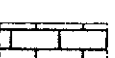
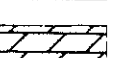
A

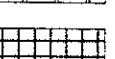

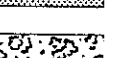
APPENDIX 2 OFFICIAL COMMUNITY PLAN LAND USE AREAS



-  Rural Staking Area - Stage 1
-  Rural Staking Area - Stage 3
-  Resource Management Area
-  Mixed Residential, Services, Retail, Commercial
-  Residential
-  Rural Residential
-  High Density Residential Reserve
-  Residential Reserve
-  School
-  School Reserve
-  Tourist Commercial with Greenbelt
-  Industrial
-  Airport Industrial
-  Recreation Reserves
 - 1. Tarahne
 - 2. Old Golf Course
 - 3. Pine Creek Campground
 - 4. Como Lake
 - 13. All islands within Atlin Lake except Second Island
-  Recreation Complex Reserve
-  Solid Waste Disposal Site
-  Town Core

Scale - 1:15000

Prepared By: **PLANNING BRANCH**
MINISTRY OF MUNICIPAL AFFAIRS, VICTORIA, B. C.

October 1981