

PROVINCE OF BRITISH COLUMBIA

Department of Lands, Forests, and Water Resources

FOREST SERVICE

IN THE MATTER OF TREE FARM LICENCE NUMBER 23

AMENDMENT NUMBER 109

Whereas the lands described hereinafter are within Tree Farm Licence Number 23 and are found to be suitable for a higher economic use;

And whereas the aforementioned lands are within a non-productive belt or area;

Therefore pursuant to subsection (14) of Section 36 of the Forest Act being Chapter 153 of the Revised Statutes of British Columbia, 1960 and pursuant to Clause 15 of the said Tree Farm Licence the following lands are herewith withdrawn from the lands described in Schedule "B" of the said Tree Farm Licence; namely, all that parcel or tract of land being more particularly shown in bold black on the sketch attached hereto and described as follows:

"an area 3.3 chains by 3.3 chains centered
at Latitude $50^{\circ} 02' 45''$ and $117^{\circ} 59' 25''$
Longitude containing 1 acre more or less."

and the said lands so withdrawn are and shall be henceforth no longer subject to or form any part of the said Tree Farm Licence Number 23.

Dated at the City of Victoria in the Province of British Columbia
this 5th day of DECEMBER 1972.



Minister of Lands, Forests, and Water Resources.

LAND DISTRICT KOOTENAY

Region No. 23 Compt. No. 7

Base 82 K/4W

BRITISH



COLUMBIA

FOREST SERVICE

EXHIBIT A

Date November 8 1972

Atlas Ref. 82 K/4 d

AMENDMENT NO. 109; T.F.L. 23

Shown Acres \pm 1 R.D. 10 Scale 40 chains = 1 inch

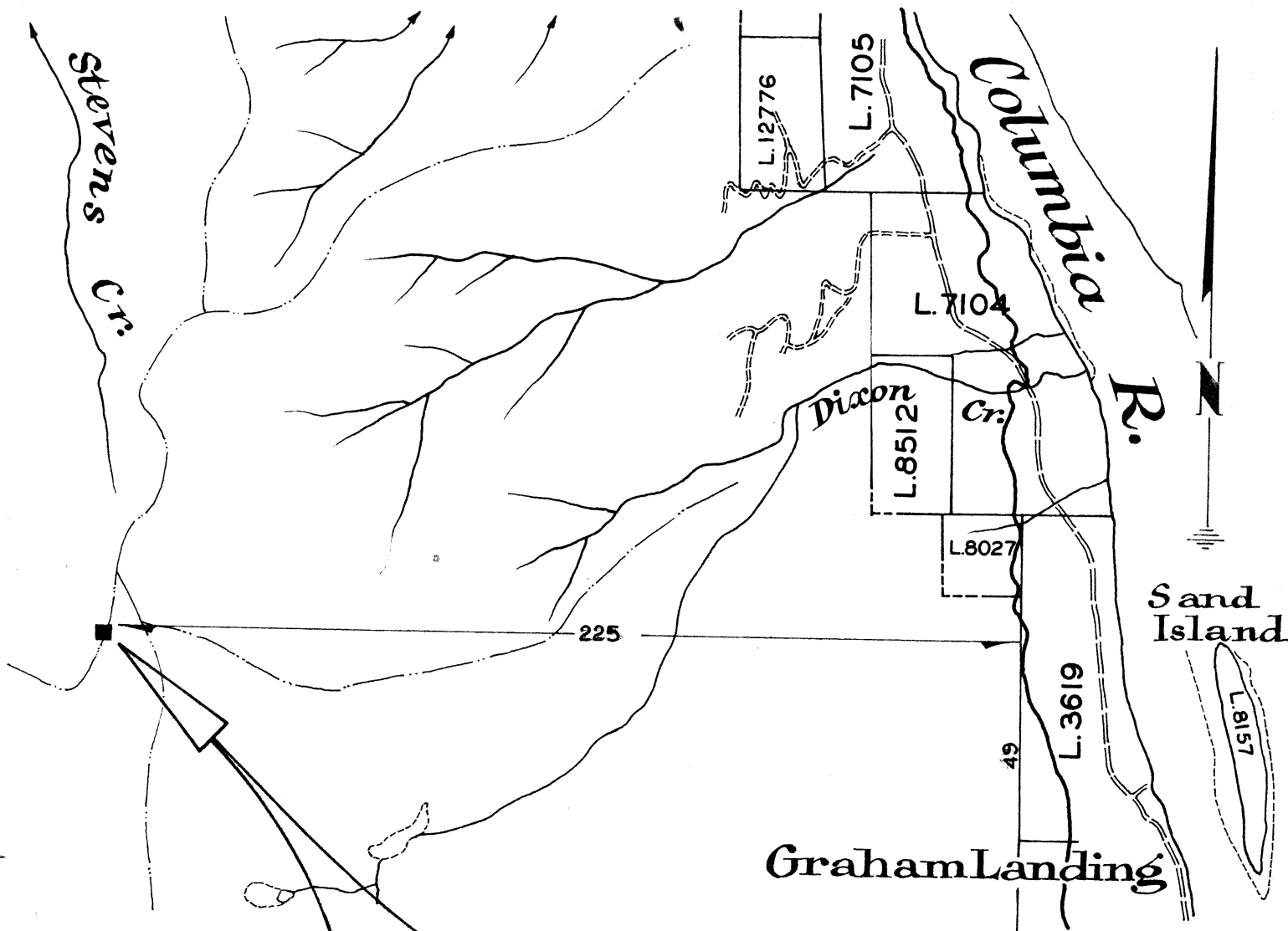

Graham Landing

