

PROVINCE OF BRITISH COLUMBIA

Ministry of Forests

IN THE MATTER OF TREE-FARM LICENCE NUMBER 19

INSTRUMENT NUMBER 51

Amendment

Whereas the lands described hereinafter are within Tree-farm Licence Number 19 and are found to be suitable for a higher economic use than the growing of forest crops;

And whereas the Licensee has requested the withdrawal of those parts of the aforementioned lands from within Schedule "A" of the said Tree-farm Licence;

And whereas the withdrawal of the aforementioned lands will not effect the sustained yield management of the said Tree-farm Licence;

Therefore pursuant to subsection (14) of section 36 of the Forest Act being Chapter 153 of the Revised Statutes of British Columbia, 1960 and pursuant to clauses 10 and 12 of the said Tree-farm Licence the following lands are hereby withdrawn from the lands described in Schedules "A" and "B" of the said Tree-farm Licence and more particularly described as follows:

Schedule "A" lands:

	<u>Hectares</u>
Part Lot 234	0.6
Part Lot 235	1.0
Part Lot 596	1.8
Part Lot 441	0.6
TOTAL:	4.0 hectares

Schedule "B" lands:

<u>Surveyed Crown land:</u>	<u>Hectares</u>
Plan 3634 RW	25.75
Plan 3671 RW	26.41
Plan 3672 RW	4.44
Plan 3672 RW	23.69
TOTAL:	80.29 hectares

all of which are shown outlined in bold black on the sketch attached hereto, and the said lands so withdrawn are and shall be henceforth no longer part of or subject to the said Tree-farm Licence Number 19.

Dated at the City of Victoria in the Province of British Columbia this 26 day of June, 1980.

Minister of Forests



Province of British Columbia
Ministry of Forests
FOREST SERVICE

EX-113
Date June 11, 1980
Ref. Map 92E/NE(a-7)
Base Forest Cover 92E EI/2
Scale 1 : 126,720

Instrument No. 51 to Tree Farm Licence No. 19

Map Of _____
Outlined _____ Area _____ hectares ±
U.T.M. _____ North _____ Reg. _____ Compt. _____ L _____
Grid _____

Forest Region 01 Vancouver
District R.D. 8
Land District Nootka

MANAGEMENT UNIT		TIMBER SUPPLY AREA		Pulpwood Agreement		Cascades	
Type	T	Number	28 Vancouver			East	
Number	T.F.L. 19	Block				West	✓
Block		Sub-B					

Area of Powerline		
L.234	0.6 ha	Plan 3622 RW
L.235	1.0 ha	Plan 3622 RW
L.596	1.8 ha	Plan 3622 RW
L.441	0.6 ha	Plan 3620 RW
Surveyed Crown Land	25.75 ha	Plan 3634 RW
"	"	26.41 ha Plan 3671 RW
"	"	4.44 ha Plan 3672 RW
"	"	23.69 ha Plan 3672 RW

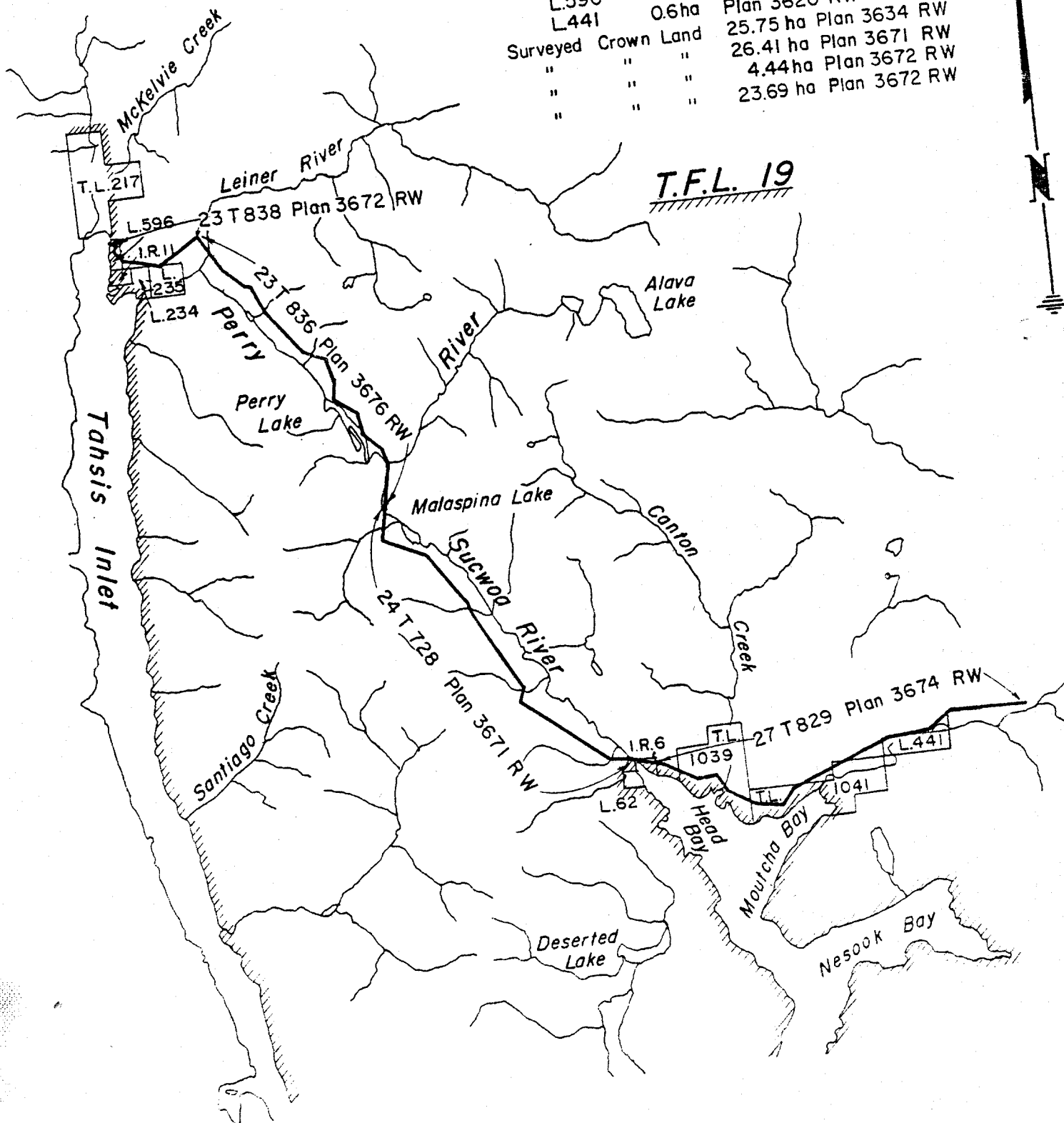

Drawn by