

82E COPY

PROVINCE OF BRITISH COLUMBIA

Department of Lands, Forests, and Water Resources

FOREST SERVICE

IN THE MATTER OF TREE FARM LICENCE NUMBER 23

AMENDMENT NUMBER 75

Whereas the lands described hereinafter are within Tree Farm Licence Number 23 and are required for a right-of-way for the purpose of power transmission;

Therefore pursuant to Subsection (14) Section 36 of the Forest Act being Chapter 153 of the Revised Statutes of British Columbia 1960 and pursuant to Clause 11 of the said Tree Farm Licence Number 23 the following lands are hereby withdrawn from the lands described in Schedule "B" of the said Tree Farm Licence that is to say all that unsurveyed land lying between Lot 8180 and Lot 10391 Kootenay Land District containing 2.87 acres, more or less, being more particularly shown outlined in bold black on the sketch map attached hereto. And the said lands so withdrawn are not and shall not be henceforth part of or subject to the said Tree Farm Licence Number 23.

Dated at the City of Victoria in the Province of British Columbia this*22nd*..... day of*June*....., 1967.

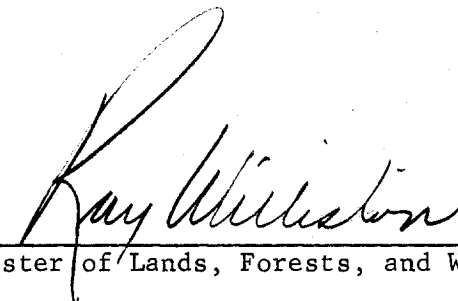
Minister of Lands, Forests, and Water Resources

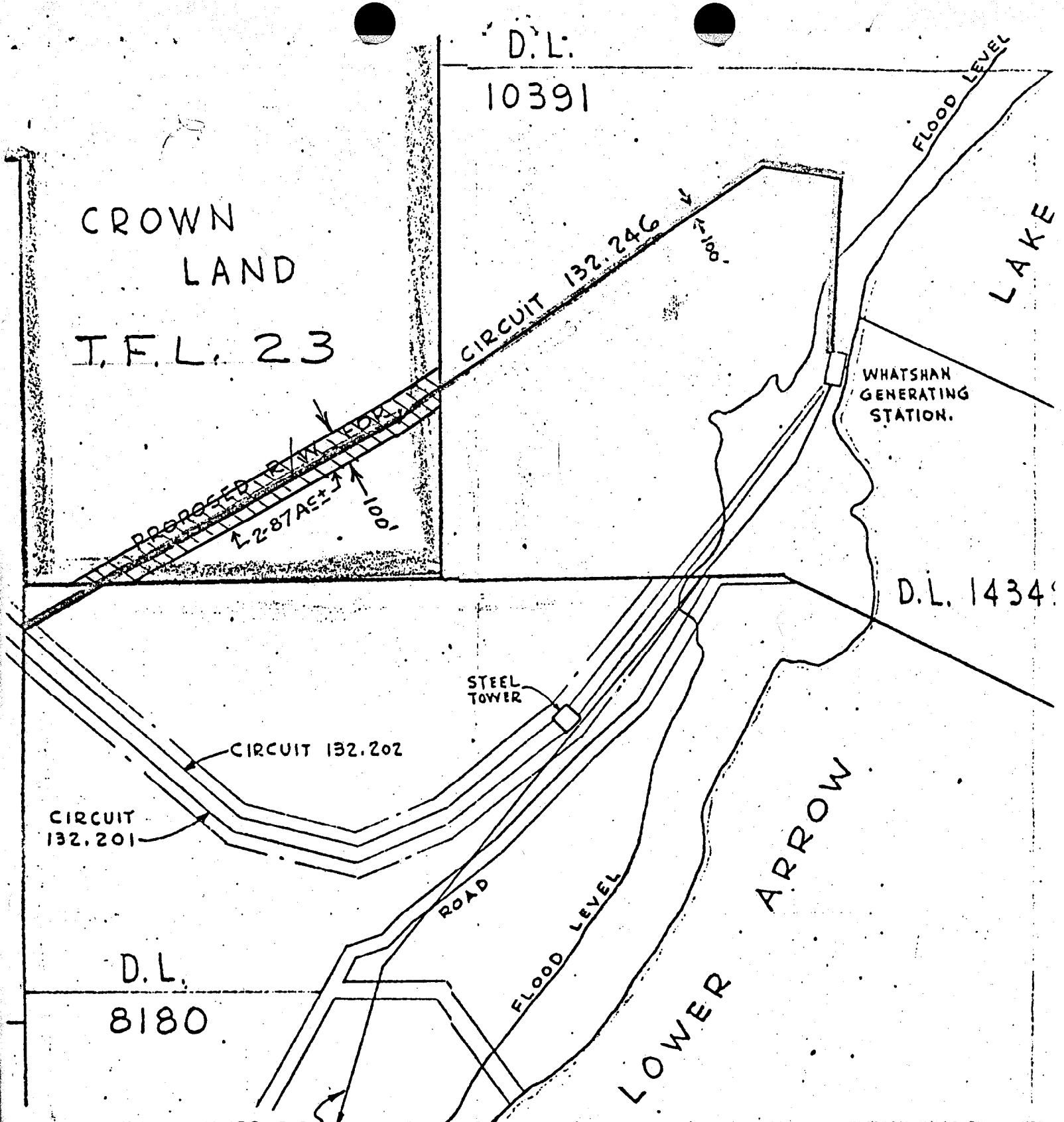

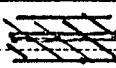
T.F.L. 23	BRITISH  COLUMBIA FOREST SERVICE	
T.F.L. 23 - AMENDMENT 75, shown thus  KOOTENAY DISTRICT		
Ref. Map. 82E/16E Plan. E.C. Hydro. Made by _____ Dept. of Lands and Forests. F.S. Draughting Room, Victoria, B.C., June 13, 1967.		

Scale: 400 feet - 1 inch