

Commercial – General

Scroll to view sample Site Plan Map

The **Commercial-General Site Plan** must include:

1. Scale e.g. 1:100 – 1:5,000
2. North arrow
3. The outer boundary of the proposed application area in relation to other legal boundaries, with lengths/dimensions and a point of commencement identified as latitude/longitude or UTM coordinate
4. All proposed and existing [improvements](#) (e.g. buildings, structures, roads, powerlines, fences, etc.) where it is clear which are proposed and which are existing. All improvements must be labeled or listed in a legend, must include coordinates and must show lengths/dimensions
5. Existing man-made or natural [features](#) within and directly surrounding the application area (e.g. waterbody, present natural boundary, height of land, contour lines where possible etc.)
6. Sources of water, means of sewage disposal, parking and proposed access (i.e. water, air, road)

Commercial – Golf Courses

Scroll to view sample Site Plan Map

The **Commercial-Golf Courses Site Plan** must include:

1. Scale e.g. 1:100 – 1:5,000
2. North arrow
3. The outer boundary of the proposed application area in relation to other legal boundaries, with lengths/dimensions and a point of commencement identified as latitude/longitude or UTM coordinate
4. All proposed and existing [improvements](#) (e.g. buildings, structures, roads, powerlines, fences, etc.) where it is clear which are proposed and which are existing. All improvements must be labeled or listed in a legend, must include coordinates and must show lengths/dimensions
5. Existing man-made or natural [features](#) within and directly surrounding the application area (e.g. waterbody, present natural boundary, height of land, contour lines where possible etc.)
6. Indicate the location on the site plan if there is a residential component
7. Sources of water, means of sewage disposal, parking and proposed access (i.e. water, air, road)

Commercial Marina

Scroll to view sample Site Plan Map

The **Commercial Marina Site Plan** must include:

1. Scale e.g. 1:100 – 1:5,000
2. North arrow
3. The outer boundary of the proposed application area in relation to other legal boundaries, with lengths/dimensions and a point of commencement identified as latitude/longitude or UTM coordinate
4. All proposed and existing [improvements](#) (e.g. buildings, structures, roads, powerlines, fences, etc.) where it is clear which are proposed and which are existing. All improvements must be labeled or listed in a legend, must include coordinates and must show lengths/dimensions
5. Existing man-made or natural [features](#) within and directly surrounding the application area (e.g. waterbody, present natural boundary, height of land, contour lines where possible etc.)
6. The lineal footage of moorage space proposed

A Side Profile drawing must be provided for any [improvements](#) in the water or crossing the foreshore. The side profile drawing must illustrate the following elements:

1. Improvements (i.e. docks, stiff-legs, anchor lines, pilings, log booms, floating storage sheds, fish pens, submarine cables)
2. The average high and low water marks
3. The profile of the ocean or lake bed underneath the improvements
4. Lengths/dimensions in meters are required to illustrate the high and low water levels under the improvement to the floor of the ocean or lake bed

Scroll to view sample Side Profile Map

Commercial – Film

Scroll to view sample Site Plan Map

The **Commercial - Film Site Plan** must include:

1. Scale e.g. 1:100 – 1:5,000
2. North arrow
3. The outer boundary of the proposed application area in relation to other legal boundaries, with lengths/dimensions and a point of commencement identified as latitude/longitude or UTM coordinate
4. All proposed and existing [improvements](#) (e.g. buildings, structures, roads, powerlines, fences, etc.) where it is clear which are proposed and which are existing. All improvements must be labeled or listed in a legend, must include coordinates and must show lengths/dimensions
5. Existing man-made or natural [features](#) within and directly surrounding the application area (e.g. waterbody, present natural boundary, height of land, contour lines where possible etc.)
6. Sources of water, means of sewage disposal, parking and proposed access (i.e. water, air, road)

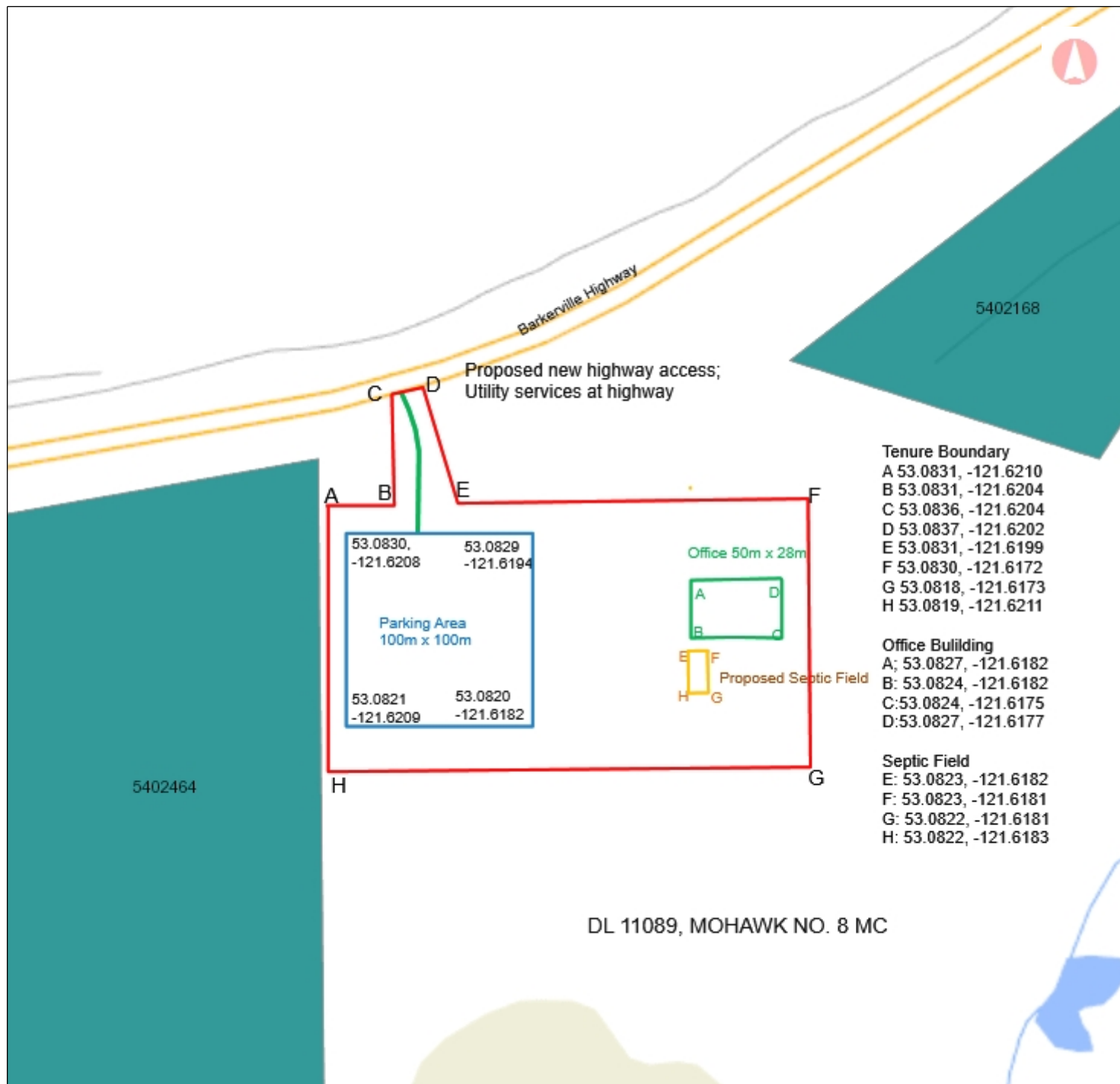

- Tenures - Tantalus - Colour f
- TileCache

0 0.06 0.12 km

1: 3,000

Copyright/Disclaimer

The material contained in this web site is owned by the Government of British Columbia and protected by copyright law. It may not be reproduced or redistributed without the prior written permission of the Province of British Columbia. To request permission to reproduce all or part of the material on this web site please complete the Copyright Permission Request Form which can be accessed through the Copyright Information Page.

CAUTION: Maps obtained using this site are not designed to assist in navigation. These maps may be generalized and may not reflect current conditions. Uncharted hazards may exist. DO NOT USE THESE MAPS FOR NAVIGATIONAL PURPOSES.

Datum: NAD83

Projection: NAD_1983_BC_Environment_Albers

Key Map of British Columbia



Legend

- Integrated Cadastral Fabric -
- Land Act Survey Parcels - T
- Integrated Cadastral Fabric -

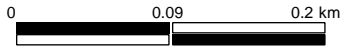

1: 4,514

Copyright/Disclaimer

The material contained in this web site is owned by the Government of British Columbia and protected by copyright law. It may not be reproduced or redistributed without the prior written permission of the Province of British Columbia. To request permission to reproduce all or part of the material on this web site please complete the Copyright Permission Request Form which can be accessed through the Copyright Information Page.

CAUTION: Maps obtained using this site are not designed to assist in navigation. These maps may be generalized and may not reflect current conditions. Uncharted hazards may exist. DO NOT USE THESE MAPS FOR NAVIGATIONAL PURPOSES.

Datum: NAD83
Projection: WGS_1984_Web_Mercator_Auxiliary_Sp here

Key Map of British Columbia



Vacant Crown Land

BC Hydro utility line

Vacant Crown Land

1 Lat: 50.69047° N
Lon: 120.32185° W

2 Lat: 50.69015° N
Lon: 120.31925° W

3 Lat: 50.68968° N
Lon: 120.31766° W

Club House

Parking Lot

8 Lat: 50.68813° N
Lon: 120.32193° W

PoC

Clubhouse 20m x 20m
• PoC 50.68934N, 120.32188W

Parking lot 60m x 20
• PoC 50.6888N, 120.3218W

7 Lat: 50.68783° N
Lon: 120.31849° W

6 Lat: 50.68724° N
Lon: 120.31857° W

Pond

4 Lat: 50.68688° N
Lon: 120.31473° W

5 Lat: 50.68625° N
Lon: 120.31608° W

Golf Course Ave

Lot A and B, DL 1234, Kamloops
Division Yale District, Plan
KAP4567

Marina Sample Map

Legend

(1:20,000) Transportation - F etc.

FCODE

- Airfield
- Airport
- Airstrip
- Airport Abandoned
- Ferry Route
- Road
- Road (Gravel Undivided) - 1 Lar
- Road (Gravel Undivided) - 2 Lar
- Road (Gravel Undivided) - U C -
- Road (Gravel Undivided) - U C -
- Road (Paved Divided) - Not Ele
- Road (Paved Divided) - Not Ele

0 0.10 0.19 km

1: 4,795

Copyright/Disclaimer

The material contained in this web site is owned by the Government of British Columbia and protected by copyright law. It may not be reproduced or redistributed without the prior written permission of the Province of British Columbia. To request permission to reproduce all or part of the material on this web site please complete the Copyright Permission Request Form which can be accessed through the Copyright Information Page.

CAUTION: Maps obtained using this site are not designed to assist in navigation. These maps may be generalized and may not reflect current conditions. Uncharted hazards may exist. DO NOT USE THESE MAPS FOR NAVIGATIONAL PURPOSES.

Datum: NAD83

Projection: WGS_1984_Web_Mercator_Auxiliary_Sphere

Key Map of British Columbia



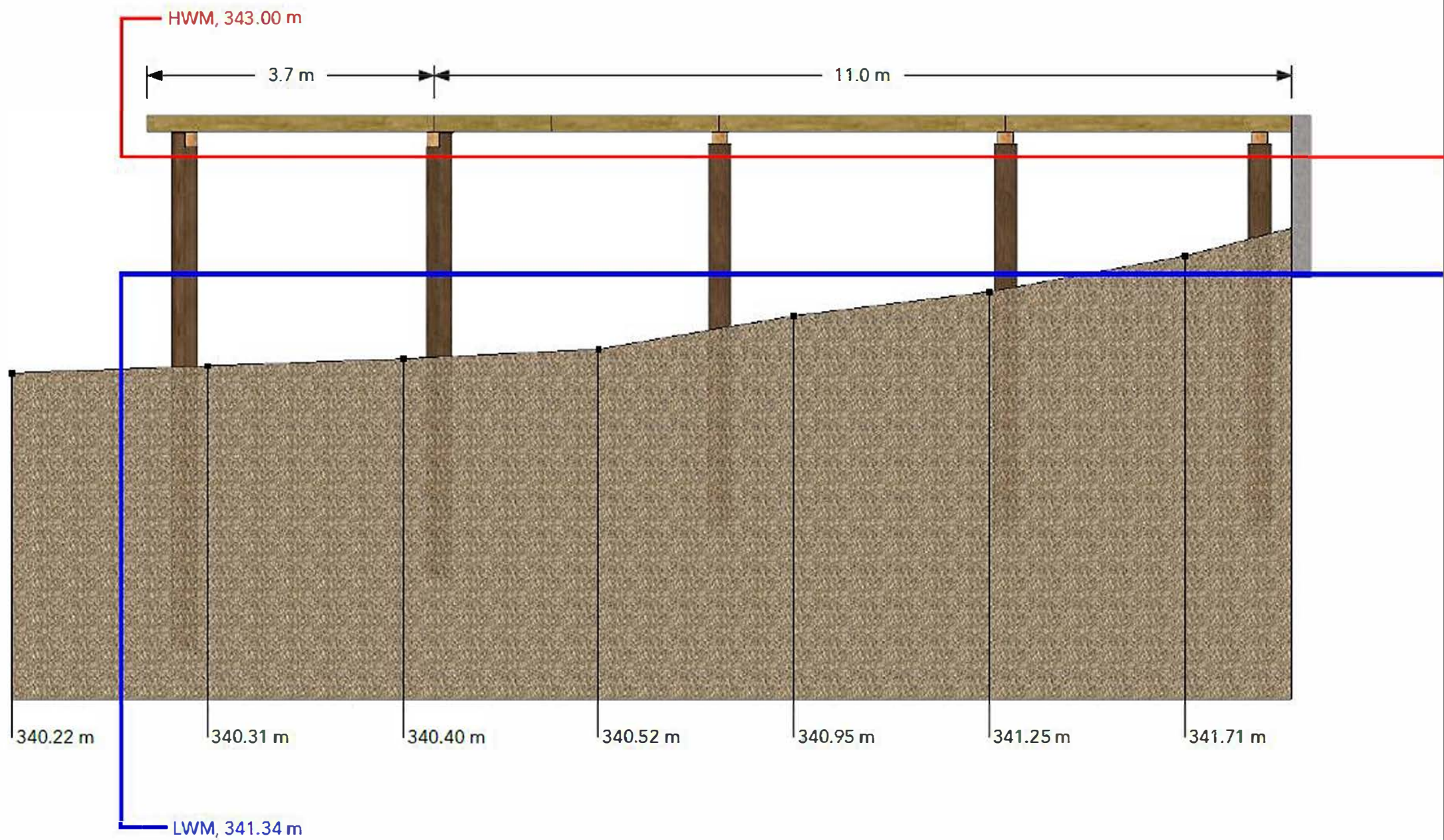

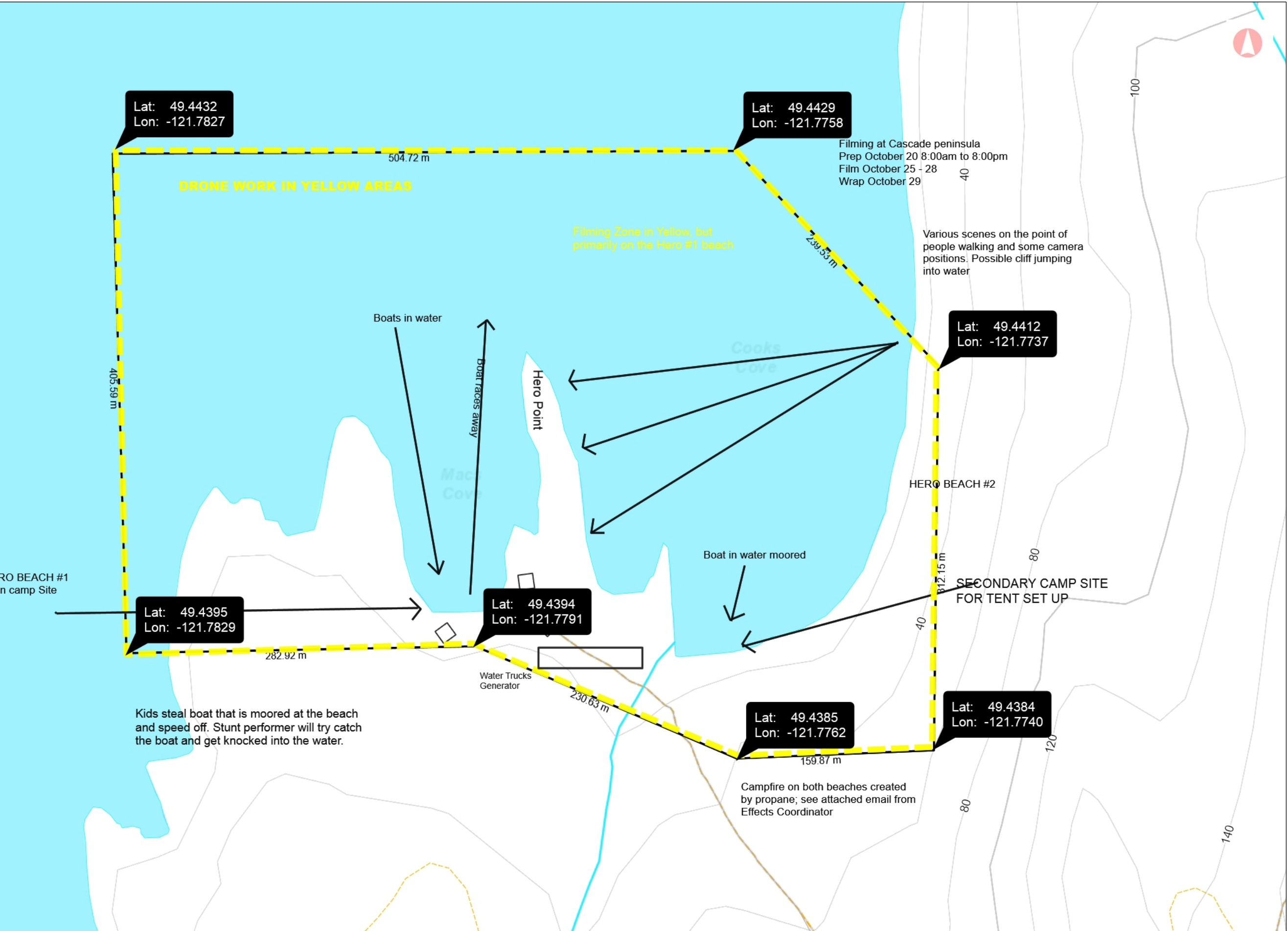

Commercial Film

Legend

Digital Road Atlas - Labels

Digital Road Atlas - Lines

ROAD_CLASS

- Ferry
- Highway
- Freeway
- Arterial
- Collector
- Ramp
- Service
- Local Road
- Strata Road
- Restricted Access
- Runway
- Lane
- Recreation
- Resource
- Skid Trail
- Driveway
- Trail
- Pedestrian Mall
- Water Access
- Alleyway
- Unknown

Water - Rivers, Creeks, Sho
(1:20,000)

FCODE

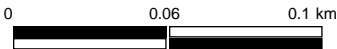

1: 3,000

Copyright/Disclaimer

The material contained in this web site is owned by the Government of British Columbia and protected by copyright law. It may not be reproduced or redistributed without the prior written permission of the Province of British Columbia. To request permission to reproduce all or part of the material on this web site please complete the Copyright Permission Request Form which can be accessed through the Copyright Information Page.

CAUTION: Maps obtained using this site are not designed to assist in navigation. These maps may be generalized and may not reflect current conditions. Uncharted hazards may exist. DO NOT USE THESE MAPS FOR NAVIGATIONAL PURPOSES.

Datum: NAD83
Projection: NAD_1983_BC_Environment_Albers

Key Map of British Columbia

