

PROVINCE OF BRITISH COLUMBIA
Department of Lands, Forests, and Water Resources
FOREST SERVICE

IN THE MATTER OF TREE FARM LICENCE NUMBER 37

AMENDMENT NUMBER 15

Whereas the lands described hereinafter are within Tree Farm Licence Number 37 and are found to be suitable for a higher economic use than the growing of forest crops;

And whereas the withdrawal of the aforementioned lands together with any lands previously withdrawn does not diminish the productive capacity of the licence area to the extent provided in Clause 10 of the Tree Farm Licence;

Therefore pursuant to subsection (14) of Section 36 of the *Forest Act* being Chapter 153 of the Revised Statutes of British Columbia 1960 and pursuant to Clause 10 of the said Tree Farm Licence the following lands are herewith withdrawn from the lands described in Schedule "B" of the said Tree Farm Licence; namely, all that parcel or tract of land being more particularly shown in bold black on the sketch attached hereto and described as follows:

"Commencing at a point 2 chains West and 1.5 chains South of the Northeast corner of Timber Licence 7224P, Rupert Land District; thence South 200 feet; thence West 200 feet; thence North 200 feet; thence East 200 feet to the point of commencement, containing 1 acre, more or less."

and the said lands so withdrawn are and shall be henceforth no longer subject to or form any part of the said Tree Farm Licence Number 37 during the term of Special Use Permit 6354 issued in respect of the aforementioned area.

Dated at the City of Victoria in the Province of British Columbia
this . . . 12th . . . day of . . . FEBRUARY . . . , 1970.



Minister of Lands, Forests, and Water Resources

AMENDMENT NO 15 TO T.F.L. 37

RUPERT L.D.

Scale: 20 chains = 1 inch

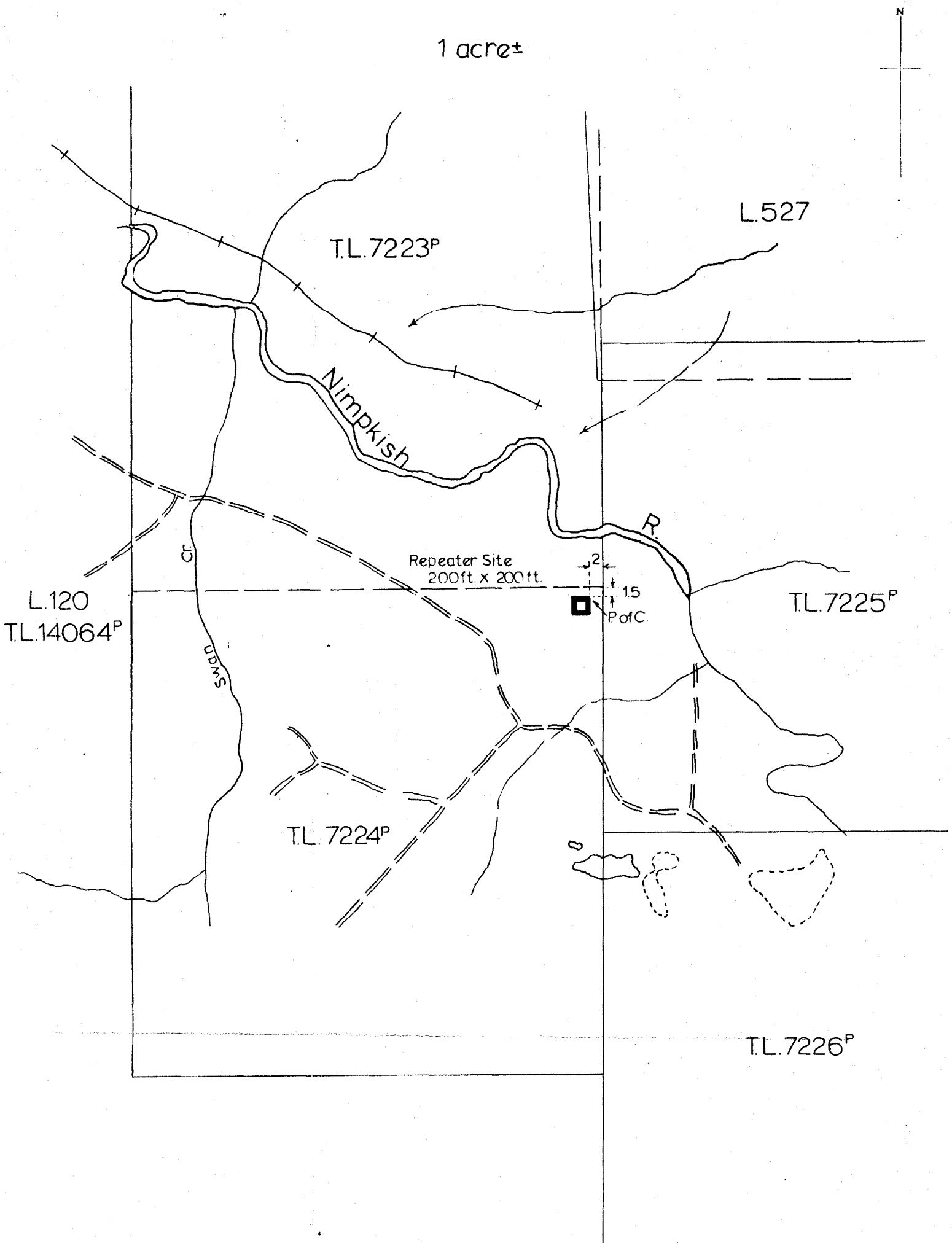
1 acre±



Lot No.	Field Book	Pigeon-hole	Date Surveyed	Reference Map 92 L/ SE (A-5)	Plan
				Sketch for	Made by A.A.
				Department of Lands, Forests, and Water Resources,	
				15, 16, 17, 18, 19, 20, 21, 22, 23, 24, 25, 26, 27, 28, 29, 30, 31, 32, 33, 34, 35, 36, 37, 38, 39, 40, 41, 42, 43, 44, 45, 46, 47, 48, 49, 50, 51, 52, 53, 54, 55, 56, 57, 58, 59, 60, 61, 62, 63, 64, 65, 66, 67, 68, 69, 70, 71, 72, 73, 74, 75, 76, 77, 78, 79, 80, 81, 82, 83, 84, 85, 86, 87, 88, 89, 90, 91, 92, 93, 94, 95, 96, 97, 98, 99, 100	