

PROVINCE OF BRITISH COLUMBIA

Ministry of Forests

IN THE MATTER OF TREE FARM LICENCE NUMBER 1

INSTRUMENT NUMBER 86

Amendment

Whereas the lands described hereinafter are within Tree Farm Licence Number 1 and are required for Forest Service Road Project 529;

And whereas the withdrawal of the aforementioned lands together with any lands previously withdrawn does not diminish the productive capacity of the licence area beyond the statutory limits;

Therefore pursuant to section 53(1)(b)(ii) of the Forest Act and pursuant to Clause 11 of the said Tree Farm Licence Number 1, the following lands are herewith withdrawn from the lands described in Schedule "B" of the said Tree Farm Licence Number 1, namely, all that parcel or tract of land being more particularly shown in bold black on the plan attached hereto, and the said lands so withdrawn are and shall be henceforth no longer subject to or form any part of the said Tree Farm Licence Number 1.

Dated at the City of Victoria in the Province of British Columbia this 3 day of Feb , 1981.

Minister of Forests



Province of British Columbia
Ministry of Forests
Forest Service

Map of INSTRUMENT No. 86 TO TREE FARM LICENSE No. 1

EXHIBIT A

Date FEBRUARY 16, 1931
Ref. Map 1031/NE-a-6, 93L/NW-a-1
Base 1031/9E, 93L/12W
Scale 1:31680
Area 28 hectares ±

MANAGEMENT UNIT			TIMBER SUPPLY AREA		Pulpwood Agreement	Cascades	
Type	02, T		Number	11		East	✓
Number	75		Block			West	
Block			Sub-B				

Forest Region 02, PRINCE RUPERT

Land District C.R. 5

U.T.M.	Zone	East						North						Compt.	L					
Grid	0	9	5	6	2	0	0	0	6	0	4	7	0	0	0	6	5	0	2	0

District 4

Outline

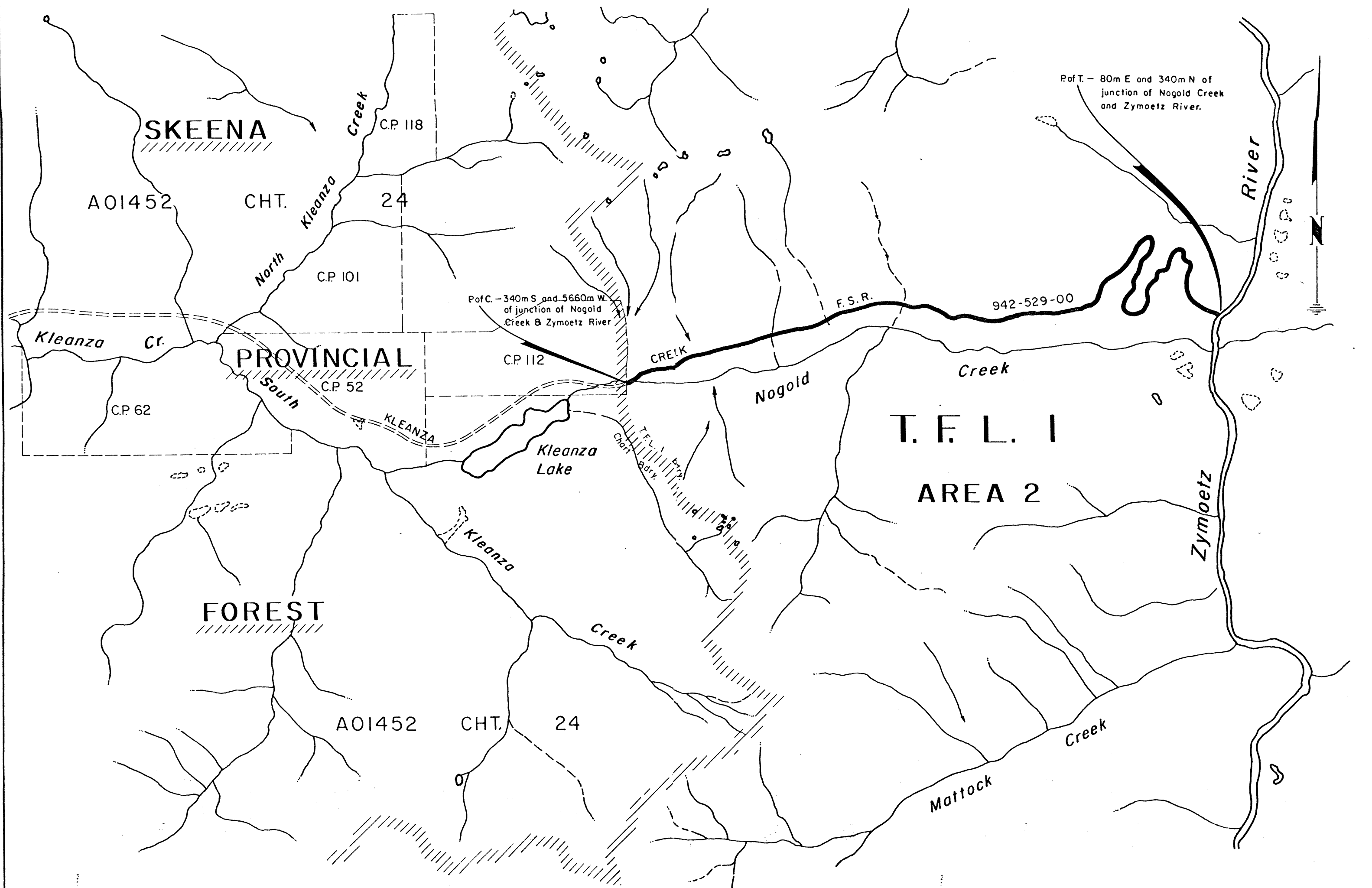

Drawn by