

Airport, Agriculture, Aggregates, Community Use and Institutional Use, Energy and Mining, Golf Courses

(Oct. 21, 2002)

Mapping Requirements

Provide a **Site Specific map** and **Site General map** on 8 ½" x 11" or 8 ½" x 14" or 11" x 17" paper only.

Submit a **Site General map** at 1:20,000 scale as indicated on the sample map. The purpose of this map is to indicate the general location of the site and illustrate the boundary lines. If the application area is a surveyed lot [or crosses or is adjacent to a surveyed lot] provide a 'to scale' copy of the Survey Plan. If the application area is not a surveyed lot, provide the length, in meters, and compass bearing, 0° to 360°, for each line of the application site boundary. Label metes and bounds description on the boundary lines on the Site Specific and Site General maps, see sample map. The Point of Commencement (PofC) for the application area must be tied to a known point such as a geographic land feature or a corner pin, of a surveyed lot, that must be shown on your map and identifiable on our reference maps. Please contact our office if you would like to purchase a 1:20,000 map sheet of the application site area. A **Site Specific map** [Management Plan] is a detailed version of the **Site General map**, showing the boundary lines [noting metes and bounds] at a scale [i.e. 1:2,000, 1:5,000, 1:10,000 scale] that allows you to show the location of all improvements [i.e. access roads, buildings noting the width, length and height, etc.] within the application area. **Applications with incomplete mapping will be returned.**

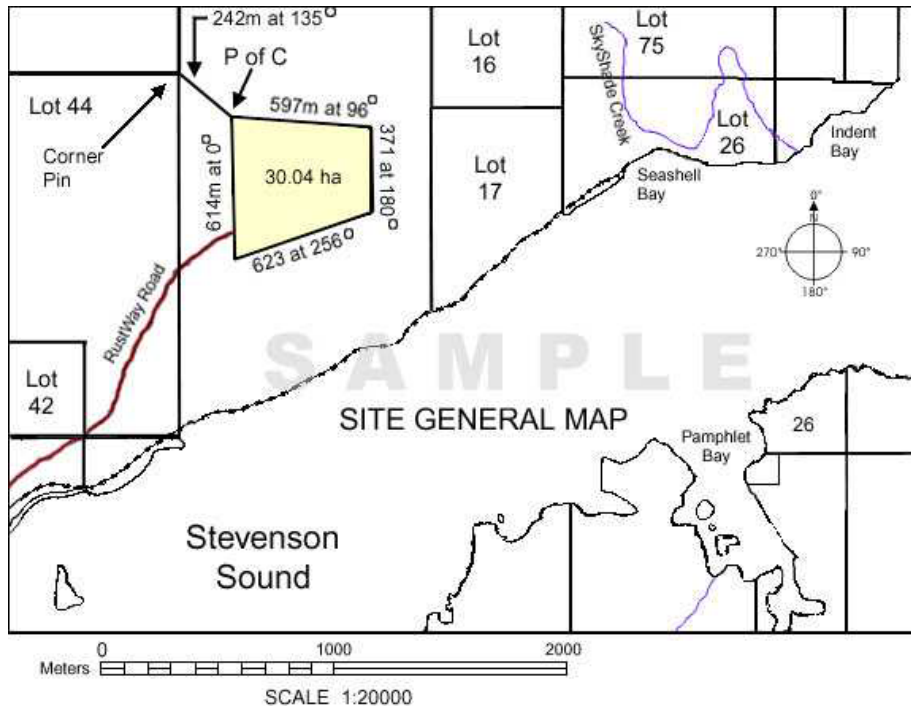

Site metes and bounds description

Begin at the northwest corner of Lot 44, Nanaimo District then go 242m at 135° to the Point of Commencement [PofC] then go:

- 597 meters at 96°
 - 371 meters at 180°
 - 623 meters at 256°
 - 614 meters at 0°
- containing 30.04 ha