

CLASS OF RIPRAP (kg)	NOMINAL THICKNESS OF RIP RAP (mm)	ROCK GRADATION PERCENTAGE SMALLER THAN GIVEN ROCK MASS (kg)		
		15%	50%	85%
10	350	1	10	30
25	450	3	25	75
50	550	5	50	150
100	700	10	100	300

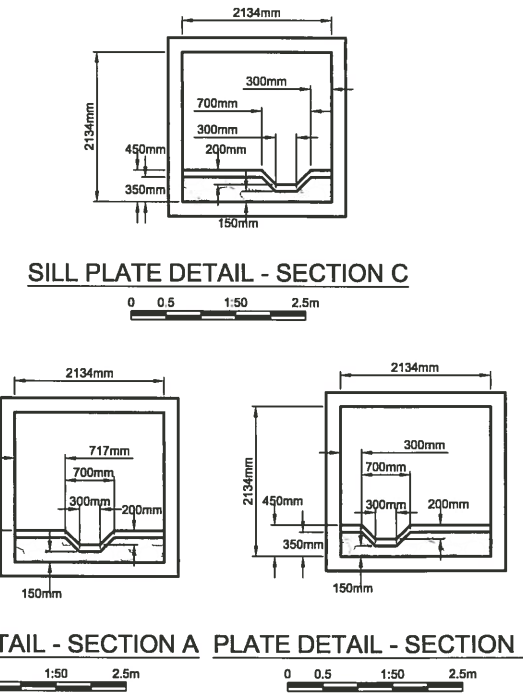

FOR PLANS SEE DWG. R1-818-101 TO 118	FOR SIGNING & PVMT MARKINGS SEE DWG. R1-818-601 TO 627
FOR PROFILES SEE DWG. R1-818-201 TO 223	FOR DRAINAGE PLANS SEE DWG. R1-818-701 TO 731
FOR TYP. SECTIONS & DETAILS SEE DWG. R1-818-301 TO 315	FOR WATERMAIN RELOCATION SEE DWG. R1-818-771 TO 774
FOR GEOMETRICS AND LANING SEE DWG. R1-818-401 TO 418	FOR SANITARY FORCEMAIN RELOC SEE DWG. R1-818-781
FOR SPOT ELEVATIONS SEE DWG. R1-818-501 TO 510	FOR SOUND WALLS SEE DWG. R1-818-801 TO 812

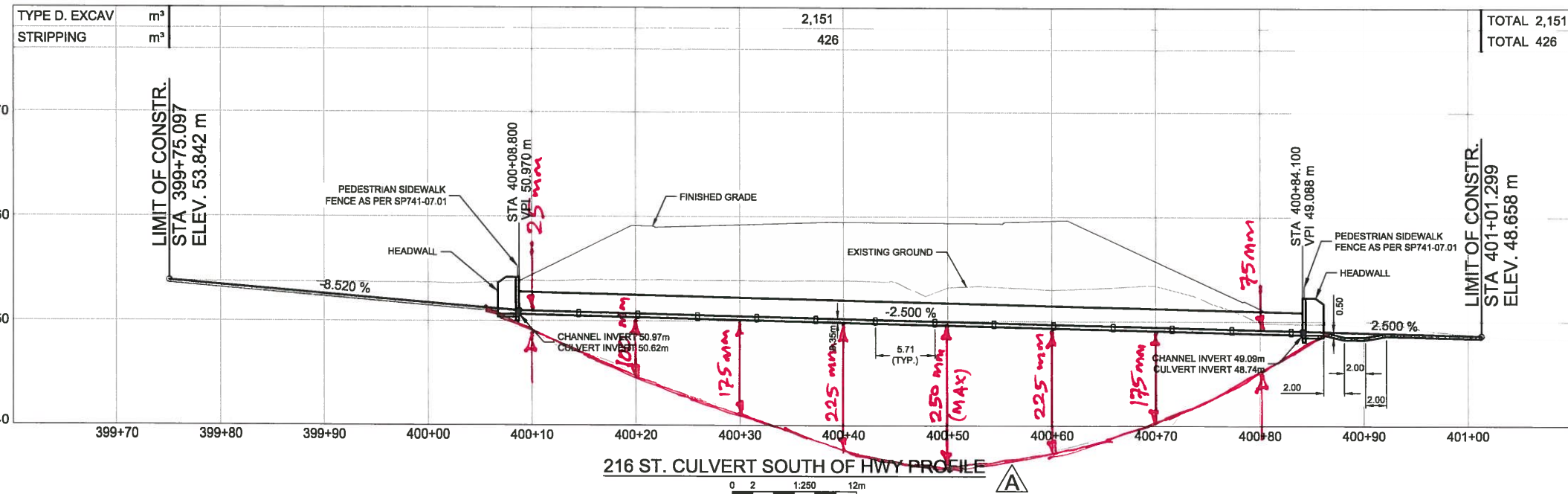
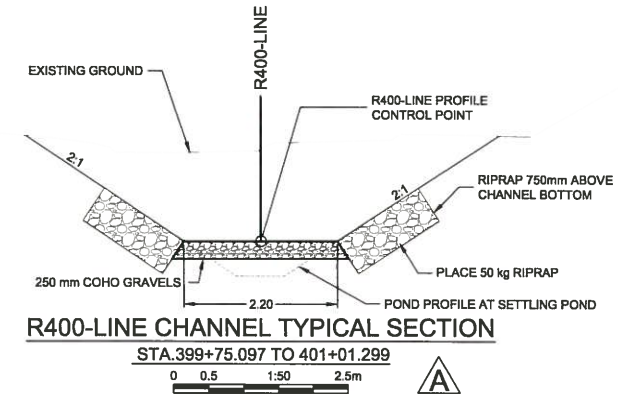
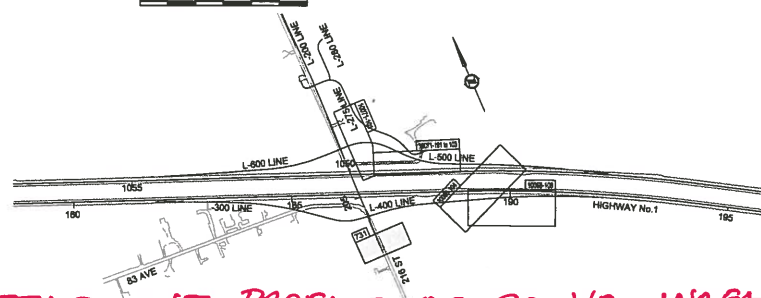

ESTIMATED SETTLEMENT PROFILE OF GROUND SURFACES ALONG THE BOX CULVERT ALIGNMENT ACROSS 216 ST. FOR EMBANKMENT FILL + 2m THICK SURCHARGE. A RANGE OF 75% TO 125% OF THE VALUES SHOWN CAN BE CONSIDERED. MM Feb. 14, 2017.

BINNIE
Your Challenges. Our Solutions. Build with Binnie.

R.F. BINNIE & ASSOCIATES LTD.
205 - 4946 Canada Way
Burnaby, BC V5G 4H7
TEL 604 420 1721
BINNIE.com

SCALE AS NOTED
CAD FILENAME 14-482-1100CSP - E41 TO E43.DWG
DATE 2017-02-09

REV	DATE	REVISIONS	SIGNATURE
A	2017-02-09	BOX CULVERT DETAILS REVISED	

MINISTRY OF TRANSPORTATION AND INFRASTRUCTURE
BRITISH COLUMBIA HIGHWAY DESIGN ENGINEERING AND GEOMATICS SOUTH COAST REGION

216 STREET BOX CULVERT PLAN AND PROFILE
HIGHWAY NO. 1
202 ST. TO 216 ST. HIGHWAY WIDENING AND 216 ST. INTERCHANGE

DESIGNED: C. HONSON DATE NOV. 2016
QUALITY CONTROL: E. BALLARIN DATE NOV. 2016
QUALITY ASSURANCE: J. MORRIS DATE NOV. 2016
DRAWN: D. SOLOKIN DATE NOV. 2016

JAMES NORRIS
SENIOR DESIGNER

FILE NUMBER	PROJECT NUMBER	REG	DRAWING NUMBER	REV
14-482	12570-0001	1	R1-818-731	A

Feb. 14, 2017 - 8:53am D:\Temp\MapInfo\2018\14-482-1100CSP - E41 to E43.dwg